

Deal
Tech
SOLUTIONS
www.dealtech.it



2024

T90 Series Catalog

T90 Series

A/B Station

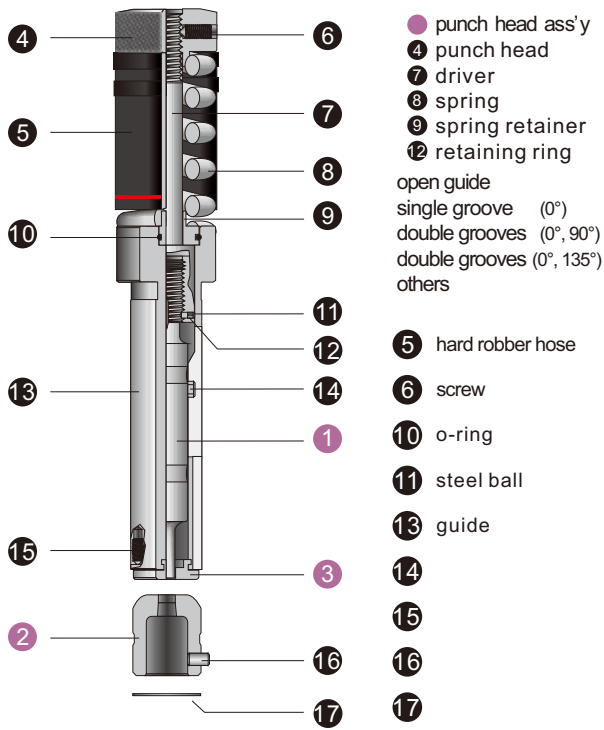

- 1 punch head ass'y
- 4 punch head
- 7 driver
- 8 spring
- 9 spring retainer
- 12 retaining ring
- open guide
- single groove (0°)
- double grooves (0°, 90°)
- double grooves (0°, 135°)
- others
- 5 hard robber hose
- 6 screw
- 10 o-ring
- 11 steel ball
- 13 guide
- 14
- 15
- 16
- 17

DESCRIPTION

- 1 Punch
- 2 Die
- 3 Stripper
- 4 Punch Head
- 5 Retainer Ring
- 6 Adjust Push Button
- 7 Canister
- 8 Disc Spring
- 9 10 11 Screw
- 12 Adjusting Shaft
- 13 Driver
- 14 Key
- 15 Guide
- 16 Spring Support
- 17 Punch Holder
- 18 Lock Washer
- 19 Screw
- 20 Screw
- 21 Screw
- 22 Stripper Clip
- 23 Ejector
- 24 Die Shim

Punch Head Assembly
 Punch Guide

A Station: ØD 1-12.7mm (1/2" ~ 1/2")

B Station: ØD 12.71-31.7mm (1/2" ~ 1-1/4")

Our's T90 series is one of Ketec's best-selling product lines, prized for its ease of use, reliability, and popularity. Our T90 series can be equipped with ABS (standard) and other industry common features. All categories are available in stations A, B, C, D and E, offering other mainstream tooling manufactures.

- Tool-free punch length adjustment is achieved by rotating the punch body clockwise or counterclockwise and locked in place by retaining ring and index pin.
- Max grind life for A & B station is 6.3mm.
- Using HRC 63 High-Speed Steel for exceptional durability in high-stress environments.
 - Guides treated with Nitriding process to enhance compressive, wear, and corrosion resistance.
 - TiCN coating available upon request for additional protection.
- Interchangeable with other mainstream tooling manufacturers.

T90 Series Parts Comparison Chart

Series	Parts	Punch Assembly	Punch Head Assembly	Punch	Die	Open Guide	Stripper Plate
T90		●	●	●	●	●	●
T90 ABS		●	●	●	●	●	●

Standard Shapes

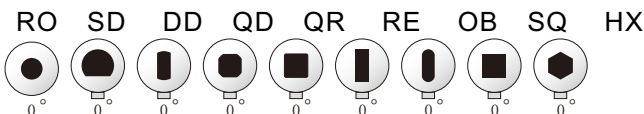

DESCRIPTION

- | | |
|----------------------|----------------------|
| 1 Punch | 13 Spring Support |
| 2 Die | 14 Lock Washer |
| 3 Stripper | 15 Screw |
| 4 Punch Head | 16 Punch Holder |
| 5 Retainer Ring | 17 Screw |
| 6 Adjust Push Button | 18 Key |
| 7 Screw | 19 Guide |
| 8 Canister | 20 Screw |
| 9 Adjusting Shaft | 21 Button Head Screw |
| 10 Disc Spring | 22 Stripper Clip |
| 11 Screw | 23 Ejector |
| 12 Driver | 24 Die Shim |

- Punch Head Assembly
- Punch
- Guide

- 4 punch head
- 5 retainer ring
- 6 adjust push button
- 7 canister
- 8 disc spring
- 9 10 11 screw
- 12 adjusting shaft
- 13 driver
- 14 key
- 15 screw
- 16 spring support
- 17 punch holder
- 18 screw
- 19 guide
- 20 screw
- 21 stripper clip
- 22 dowel pin
- 23 ejector
- 24 die shim

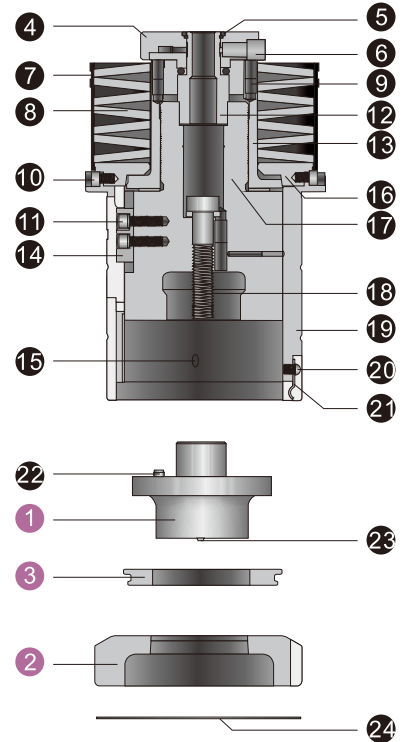

C Station: ØD 31.71-50.80mm (1-¼"~2")

D Station: ØD 50.81-88.90mm (2"~3-½")

E Station: ØD 88.91-114.30mm (3-½"~4-½")

PRODUCT OVERVIEW

Our's T90 series is one of Ketec's best-selling product lines, prized for its ease of use, reliability, and popularity. Our T90 series can be equipped with ABS (standard) and other industry common features. All categories are available in stations A, B, C, D and E, offering other mainstream tooling manufactures.

T90 Series Parts Comparison Chart

Series	Punch Assembly	Punch Head Assembly	Punch	Die	Guide	Guide Assembly	Stripper Plate
T90	●	●	●	●	●	●	●
T90 ABS	●	●	●	●	●	●	●

- Tool-free punch length adjustment is achieved by pressing the quick adjust button and rotating the punch head clockwise or counterclockwise.
- Max grind life for C, D, E station is about 8mm
- Using HRC 63 High-Speed Steel for exceptional durability in high-stress environments.
- TiCN coating available upon request for additional protection.
- Rooftop shear available upon request.
- Comes in 3 standard guiding pin angles of 0 90, 225.
- Interchangeable with other mainstream tooling manufactures.

Standard Shapes

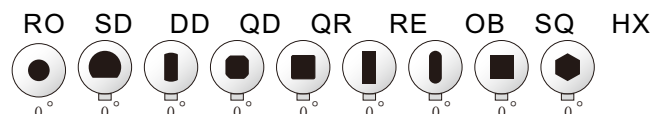

Deal Tech

SOLUTIONS

www.dealtech.it

< Phone number

+39 0541-647041

< Email

info@dealtech.it

sales@dealtech.it

< WhatsApp

< Follow us

< Address

Viale Finale ligure, 15
Riccione (RN)-47838
Italy-IT